

# RESERVATION FORM

(Deadline for reservations is June 1, 2012 - 1<sup>st</sup> come, 1<sup>st</sup> serve)

Contact Information		
Name: _____		
Address: _____		
City: _____	State: _____	Zip Code: _____
Email Address: _____		
Home Phone: _____		Cell Phone: _____
Masonic Lodge Name & No.: _____		
District: _____		

Room / Site Information	
<input type="checkbox"/> Tent or RV Site \$20 night/ \$50 – 3 nights	<input type="checkbox"/> Room \$25 night/\$60 – 3 nights
For Rooms ONLY – Type of Room	
<input type="checkbox"/> Individual	<input type="checkbox"/> Shared (spouse or children)
Names of guest: _____	Age: _____ Gender: _____
Names of guest: _____	Age: _____ Gender: _____
Names of guest: _____	Age: _____ Gender: _____
Names of guest: _____	Age: _____ Gender: _____
Dates staying: <input type="checkbox"/> Thursday, June 21 <sup>st</sup> <input type="checkbox"/> Friday, June 22 <sup>nd</sup> <input type="checkbox"/> Saturday, June 23 <sup>rd</sup>	
<b>Checks ONLY – Payable to:</b> <b>Camp Turk – St. John’s Day Event, 2150 Bleecker Street, Utica, NY 13501</b>	

Meals				
Since we have to plan ahead for meals, we would like to know if you are planning on eating in the camp dining hall. Please put # of guests eating each meal in chart below.				
	<b>Thursday</b>	<b>Friday</b>	<b>Saturday</b>	<b>Sunday</b>
<b>Breakfast</b>	N/A			
<b>Lunch</b>	N/A		N/A	N/A
<b>Dinner</b>		N/A		N/A
<b>Meal plan</b>				
Thursday Dinner – hamburger, salad & drink - \$5.00 OR hotdog, salad & drink - \$4.00				
Friday Breakfast – buffet – adults - \$7.00 kids under 12 - \$5.00				
Friday Lunch – choice of sandwich – cold cuts, salad and a drink \$5.00				
Friday Dinner – N/A				
Saturday Breakfast – buffet – adults - \$7.00 kids under 12 - \$5.00				
Saturday Lunch – N/A				
Saturday – Chicken BBQ – adults - \$8.00 – kids under 12 - \$6.00				
Sunday Breakfast – buffet – adults - \$7.00 kids under 12 - \$5.00				
<b>***You DO NOT need to send money in for this now, you will pay for meals at camp. This is just an idea so we know how much food to order.</b>				
***There are no open fires allowed at camp.				
***Meals will be CASH only!				

(OVER)

## Reservation Facts

### Bathroom Facilities:

- For campsites there will be port-a-johns on located on the field near the campsites along with a designated building (which will be a distance from the site).
- For RV's (same as above)
- For rooms bathrooms are located in each building (no rooms have individual bathrooms) SEE MAP OF EAST & WEST WING

### Shower Facilities:

- For campsites a designated building will be assigned
- For RV's (same as above)
- For rooms there are showers located in each building (no rooms have individual showers) SEE MAP OF EAST & WEST WING

\*\*\*Keep in mind this is a children's camp and the bathroom/shower facilities are designed for a camp setting. Rooms have a bed and dresser ONLY. Rooms are on a first come, first serve basis.

### RV Information:

- No electric hookup
- No dumping station
- Potable water will be available

WIFI is available in the camp office

## Check Off List

- Fishing License & equipment
- Flashlight / lantern
- Bedding (twin or double)
- Sleeping Bag
- Pillow
- Towels
- Toiletries

## RULES

**Waterfront hours**  
(for swimming & boating)  
(a lifeguard will be on duty)

**Thursday**  
1 pm to 5 pm  
6 pm to 8 pm

**Friday**  
9 am to Noon  
1 pm to 5 pm

**Saturday**  
5 to 8 pm

**Sunday**  
9 am to 1 pm

### Waterfront

Swimming & boating  
ONLY when lifeguard on duty  
Lifejackets must be WORN when out in boats  
Kayaks & paddle boats ONLY  
Rowboats for fishing ONLY

### Fishing

Over 16 must have valid NYS lic.  
From shore dusk until dawn  
From row boats during waterfront hours only (can't bring own boat)  
Bring own fishing gear  
Lifejackets must be WORN!  
No bait fish – worms, grubs, etc. or lures  
No fishing in swimming area

### General

No open camp fires  
Quiet hours  
11 pm to 7 am  
Children under 14 must be supervised at all times  
RV's must be self contained  
NO Smoking allowed  
NO Alcohol allowed  
NO Pets allowed  
MAX. 2 tents to site

**West Wing  
Sleeps 33 Staff**

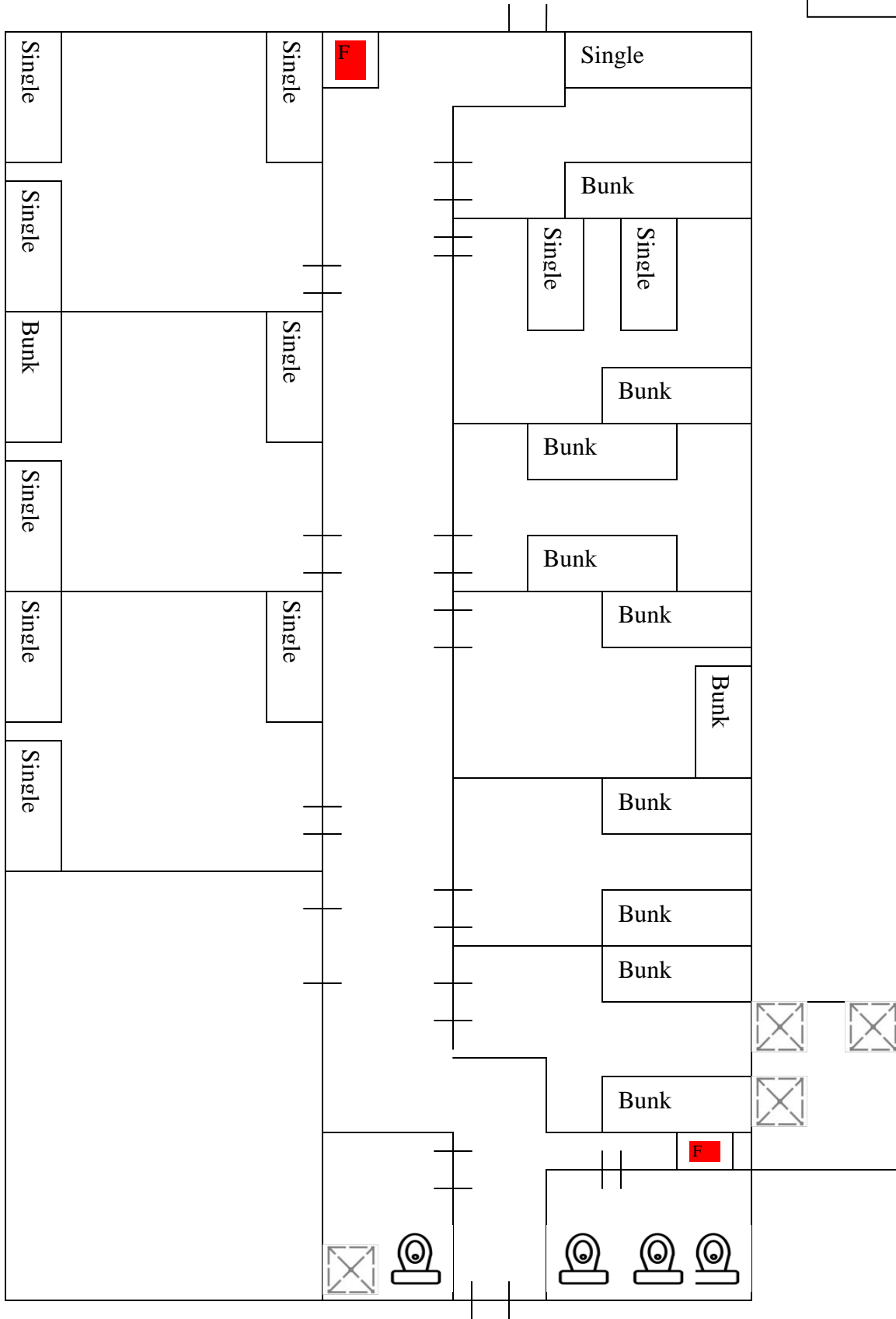

**East Wing  
Sleeps 18 Staff**

